

# Mrs. Santa Claus

## PILLOW TUTORIAL

### MATERIALS AND CUTTING

	7" x 15"	(2) 2 ½" x 3"	1
		(1) 2 ½" x 12 ½"	2
	9" x 18"	(1) 2 ½" x 12 ½"	3
		(2) 2 ½" x 16"	4
Pillow Backing	1 FQ	(2) 11 ½" x 16 ½"	5
Backing Fabric	1 FQ	18" x 18"	
Batting		18" x 18"	
Binding	¼ yard	(2) 2 ¼" x WOF	

### INSTRUCTIONS

Finished pillow size: 16 ½" x 16 ½"

Follow the steps below to assemble the pillow. Use a ¼" seam allowance and press the seams as shown by arrows.

Make one 12" MRS. SANTA CLAUS quilt block.

The pattern can be purchased as a immediate PDF download here:

<https://www.etsy.com/de/shop/ellisandhiggs>

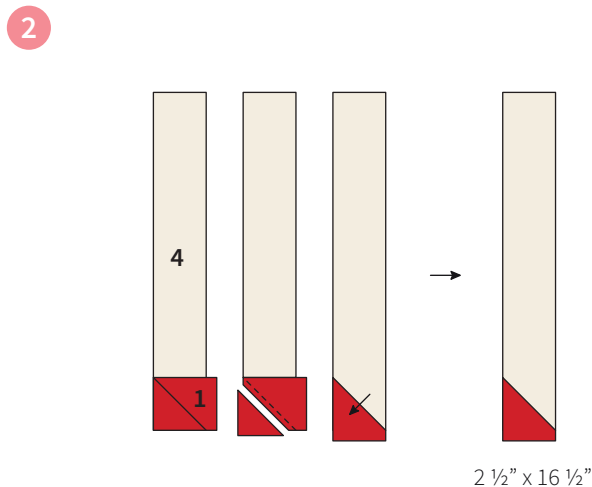
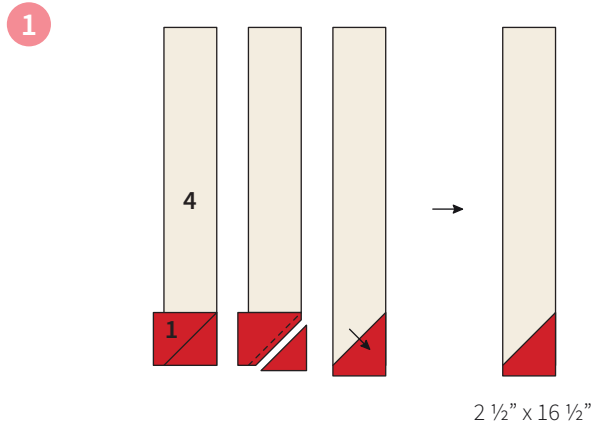

3

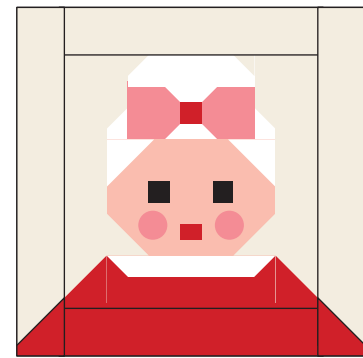
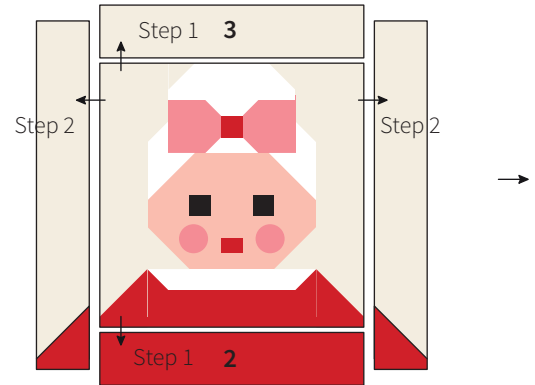

Pillow Top should measure 16 ½" x 16 ½"

### PILLOW ASSEMBLY

Make a quilt sandwich with your pillow top, batting and backing fabric and quilt as desired. Trim excess batting and fabric.

To create a hem, place a Fabric E rectangle wrong side up, fold over the long edge ½" twice and press. Stitch in place. Repeat and make two. Pillow Backing should measure 11 ½" x 16 ½".

Align the backing pieces, right sides up and raw edges aligned, against the back of the Pillow Top. The hemmed edges should overlap 4 ½". Pin the backing in place and machine baste ⅛" from the edge.

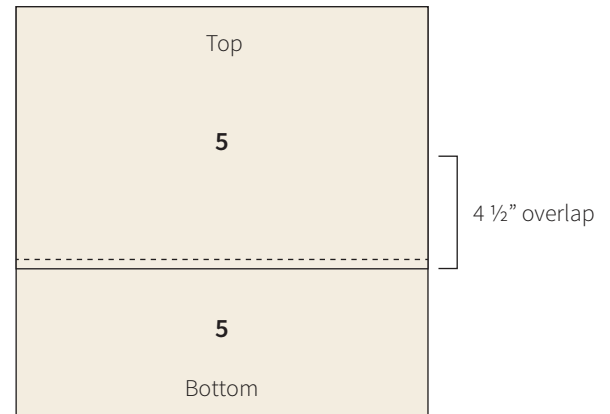





### FINISHING

Piece the binding strips end to end and bind the pillow using your favorite binding method.

# Santa Claus

## PILLOW TUTORIAL

### MATERIALS AND CUTTING

	6" x 14"	(2) 2 1/2" x 5 1/2"	A
		(1) 2 1/2" x 12 1/2"	B
	9" x 15"	(1) 2 1/2" x 12 1/2"	C
		(2) 2 1/2" x 13 1/2"	D
Pillow Backing	1 FQ	(2) 11 1/2" x 16 1/2"	E
Backing Fabric	1 FQ	18" x 18"	
Batting		18" x 18"	
Binding	1/4 yard	(2) 2 1/4" x WOF	

### INSTRUCTIONS

Finished pillow size: 16 1/2" x 16 1/2"

Follow the steps below to assemble the pillow. Use a 1/4" seam allowance and press the seams as shown by arrows.

Make one 12" SANTA CLAUS quilt block.

The pattern can be purchased as a immediate PDF download here:

<https://www.etsy.com/de/shop/ellisandhiggs>

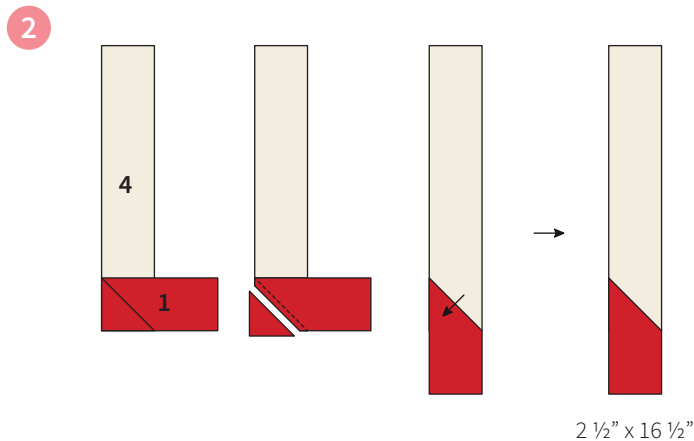
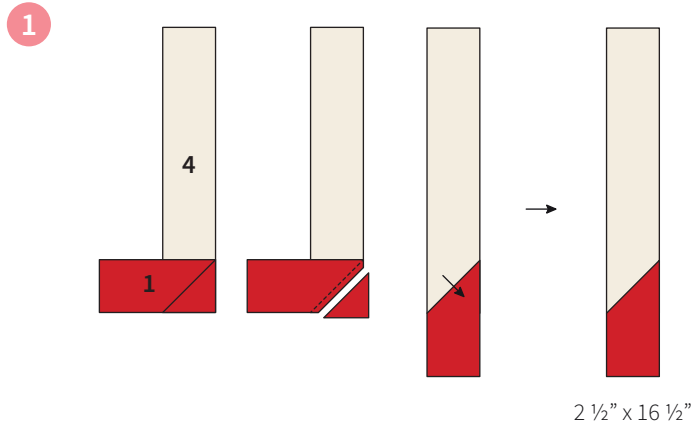

**3**

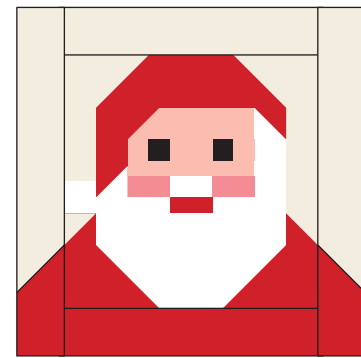
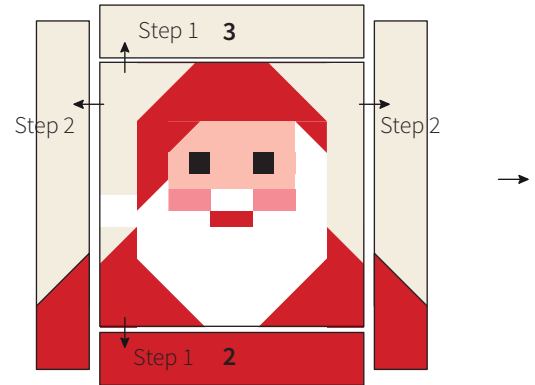

Pillow Top should measure 16 1/2" x 16 1/2"

### PILLOW ASSEMBLY

Make a quilt sandwich with your pillow top, batting and backing fabric and quilt as desired. Trim excess batting and fabric.

To create a hem, place a Fabric E rectangle wrong side up, fold over the long edge 1/2" twice and press. Stitch in place. Repeat and make two. Pillow Backing should measure 11 1/2" x 16 1/2".

Align the backing pieces, right sides up and raw edges aligned, against the back of the Pillow Top. The hemmed edges should overlap 4 1/2". Pin the backing in place and machine baste 1/8" from the edge.

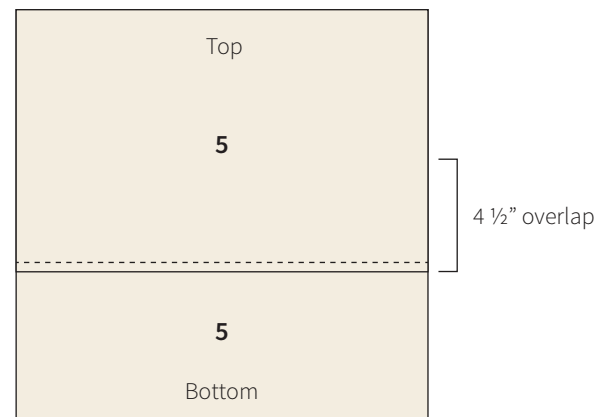

### FINISHING

Piece the binding strips end to end and bind the pillow using your favorite binding method.